

Heaters

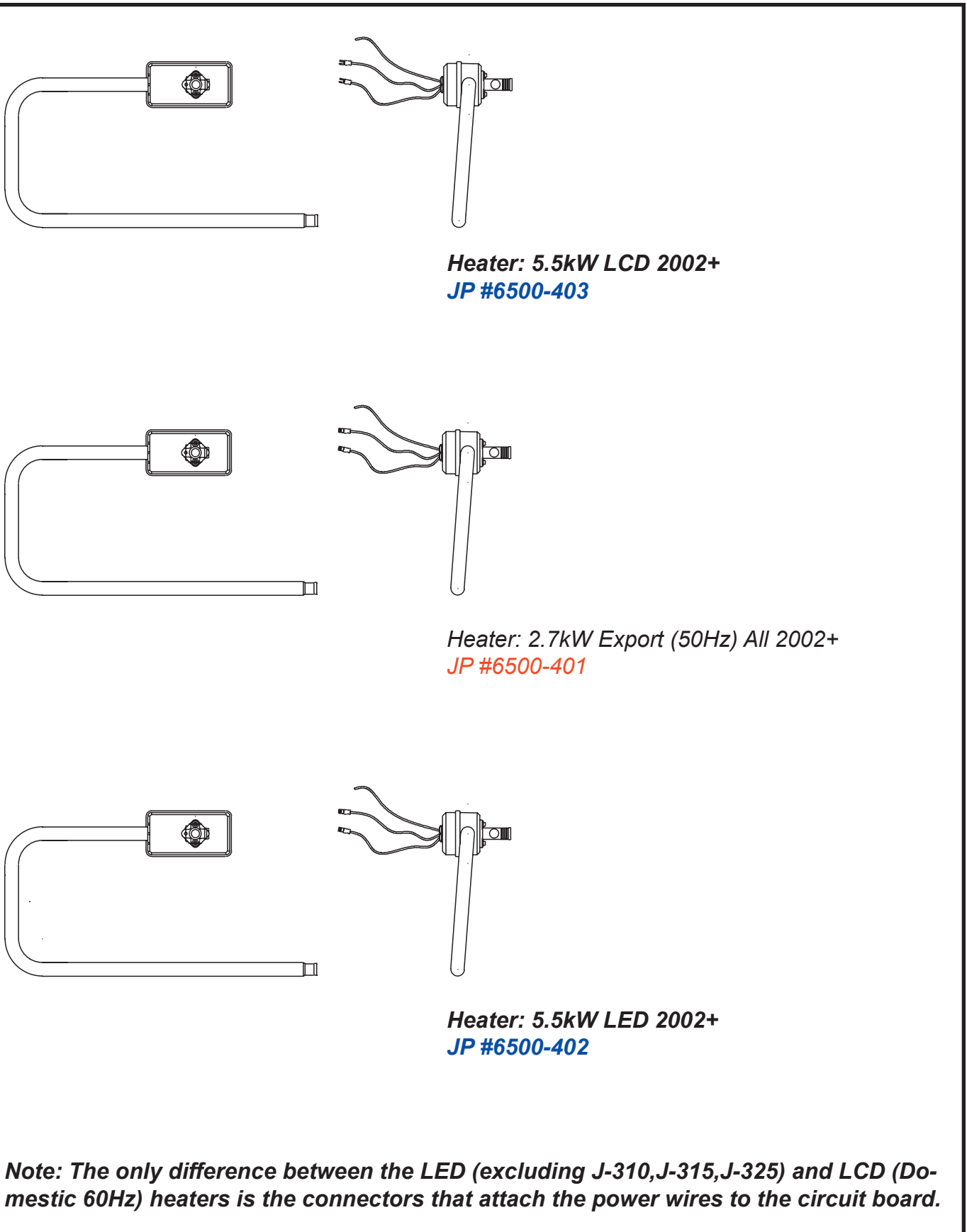

Note: The only difference between the LED (excluding J-310,J-315,J-325) and LCD (Domestic 60Hz) heaters is the connectors that attach the power wires to the circuit board.

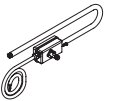

Heaters

2002 - 2003 J-310 / 2004+ J-315, J-325 Heater

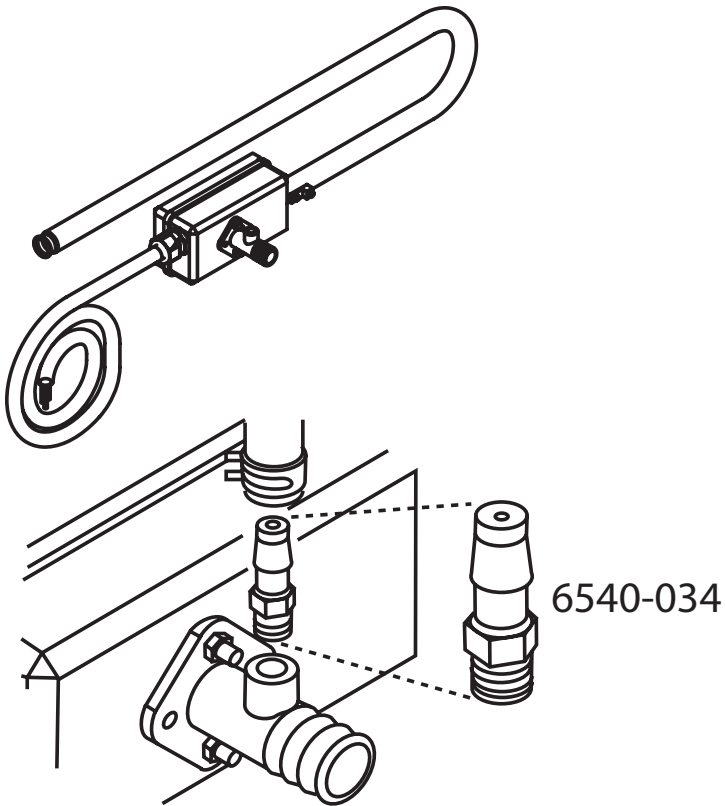

Heater: 1kW/4kW 120V/240V J-310,J-315,J-325
JP #6500-063

Heater: 2.7kW 230V (50Hz) J-310,J-315,J-325
JP #6500-062

Adapter: MPT 1/8 x 3/8 Barb (J-310 Freeze Line)
JP #6540-034

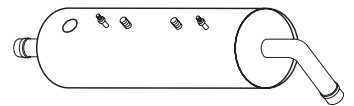

Heaters

2000 - 2001 Platinum Series

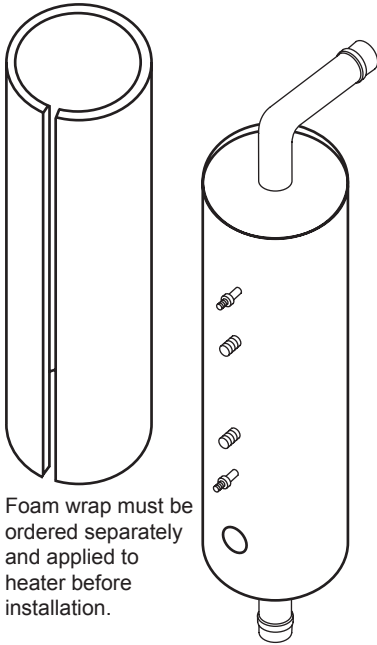

Foam wrap must be ordered separately and applied to heater before installation.

Heater: 5.5kW Vertical
JP #6500-301
JWB #R743000

Insulation Foam: Vertical Heater
JP #6560-012
JWB #R328000

Used on Models: R270, R300, R280, R290, R310, S125, and all 2001 Platinum Series models.

Select Series

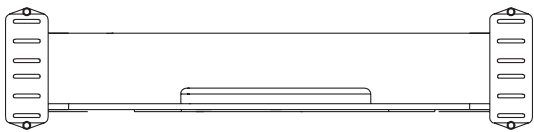

Heater: 5.5kw Select Series
JP #2600-050
JWB #F802000

Nut: Split Replacement 2"
JP #6000-176

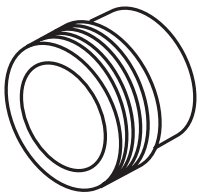

Tailpiece: Heater Select Series
JP #6560-005
JWB #F803000



O-ring: Union Fitting
JP #6560-044

Used on Models: M450, K010, R275, R295, J140, E790, N800, N825, F290, F291, F292, K770, F160, N750, H870, F300, E800, F280, E400, H880, H860, H890, and all 2001 Select Series models.

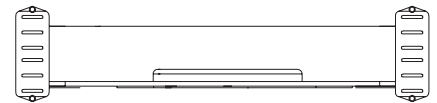

Heaters

Older Heaters and Echo Heaters

<i>Description</i>	<i>JP #</i>	<i>JWB #</i>	<i>Model #</i>
Heater Indicator Repair Assembly	2000-132	7759000	All SCM Models
240V - 12kW Heater Element	2000-134	2209000	Avanza, Quanta, Cambio
Heater Connection Repair Kit	2000-175	D149000	All SCM Models
Heater: 6kW Low Flow (1997-1999)	2000-300	K464000	P700, P725, K100, K780
Heater Assembly PS-1	2000-301	P516000	Z101, N925
Heater: Select Series Palio	2000-302	R792000	Z112, R400
			D600, 5250, 5600, 5630, 6925, 6950,
Heater: 1.5kW 120V Alexa	2000-303	5251000	7000, 7100, 7200, 8390, 8395, 8400,
			8405, 8410
Heater: Assembly 6kW			6500, 7100, 7200, 7700, 8200, 8400,
comes with thermostat and	2000-304	6521000	8405, 8780, 8790, 8800, 8900, 9200,
hi-limit sensor			9400, C400, C460, C600
Tailpiece: 1.5" Heater Union	2000-678	S930000	Included w/2000-302
O-ring: 1.5" Heater Union	2000-679	S931000	Included w/2000-302
Heater: Assembly 1.0/4.0kW	2000-680	S943000	Use Part #2000-688
Heater: Assembly 5.5kW	2000-681	S944000	Use Part #2000-684
Heater: Assembly 1.0kW	2000-682	T041000	Use Part #2000-302
Heater: Assembly 5.5kW 240V	2000-684	R793000	S270, S280, R560
Heater: Assembly 4.0kW 240V	2000-688	S872000	S260, H490, H240